

**MENDOCINO COUNCIL OF GOVERNMENTS
REGIONAL IMPROVEMENT PROGRAM (RIP) - APPLICATION FORM**

Applicant Agency: City of Willits

Date: 10/1/2013

Project Contact: Tom Mannatt

Telephone: (707)459-4605

PROJECT INFORMATION (USE ADDITIONAL SHEETS AS NECESSARY)

Project Mode: *(Check One)*

Highways/Streets/Roads Transit Bike & Pedestrian Rail

Project Category: *(Check One)*

Safety Construction Reconstruction Capital Acquisition

Project Title: Baechtel Road - Railroad Avenue Corridor Phase I

Project Purpose:

Ease traffic congestion; provide safe pedestrian, bicycle and public transit routes.

Project Location:

The project area is located between East Valley Street and the Baechtel Road /Highway 101(Main Street) intersection. Phase I extends the entire length of Railroad Avenue beginning at the intersection of East Valley Street and Railroad Avenue and ending at its terminus at the Railroad Avenue Bridge.

Project Description:

In 2001, Caltrans awarded the City of Willits a Community Based Transportation Planning grant to complete a study and conceptual design of an east side distributor roadway system connecting Baechtel Road and Railroad Avenue. This roadway system will relieve congestion, promote infill activities, provide bicycle and pedestrian pathways, and provide a link connecting the housing, employment, and recreational facilities on the east side of the City.

The overall project will be broken up into three phases. Phase I will encompass the entirety of Railroad Avenue from East Valley Street to Barbara Lane, Phase II will be from the intersection of Baechtel Road and Highway 101 to the Shell Lane and Baechtel Road intersection, and Phase III will consist of acquiring right of way and constructing a new road between the current southern terminus of Railroad Avenue and the Shell Lane/Baechtel Road intersection. Planning for the entire route will be completed within the next one to two years using other funding sources.

The City is seeking funding at this time for construction of Phase I, Railroad Avenue between the East Valley Street Bridge and Barbara Lane. Funding for PS&E for Phase I will be provided by the City of Willits.

The objective of the greater project is to construct a connecting roadway between Baechtel Road and Railroad Avenue, creating a north-south connector through the City which will:

- Relieve congestion on Highway 101/Main Street by providing an alternative north/south route through town.
- Accommodate infill development by providing access to large vacant and under-utilized parcels that currently have very limited access to public streets.
- Create a public right-of-way for an eventual City water main connection.

TOTAL PROJECT (ALL PHASES)

			<u>Committed</u>	<u>Pending</u>
Proposed Funding:	Total Project	\$ <u>12,100,000</u>	_____	_____
	RIP Request	\$ <u>1,626,460</u>	_____	<u>\$1,626,460</u>
	City	\$ <u>445,720</u>	<u>\$445,720</u>	<u>\$2,000,000</u>
	County	\$ _____	_____	_____
	State	\$ _____	_____	_____
	Federal	\$ _____	_____	_____
	Other	\$ _____	_____	<u>\$8,000,000</u>

PHASE 1

			<u>Committed</u>	<u>Pending</u>
Proposed Funding:	Total Project	\$ <u>2,072,180</u>	_____	_____
	RIP Request	\$ <u>1,626,460</u>	_____	<u>\$1,626,460</u>
	City	\$ <u>445,720</u>	<u>\$445,720</u>	_____
	County	\$ _____	_____	_____
	State	\$ _____	_____	_____
	Federal	\$ _____	_____	_____
	Other	\$ _____	_____	_____

Leverage: Requested RIP Funds/Total Funding Needs: \$1,626,460 / \$2,070,180

What alternative sources of funding have already been sought for this project?

Source: Transportation Planning Grant *Date:* 2012 *Status:* Denied *Date Funding Available:*

Project Costs

Construction & Engineering Estimate for the Baechtel Rd - Railroad Avenue, Phase I				
Description	Unit	Quantity	Unit Price	Total
Mobilization, Insurance, Permits	LS	1	\$50,000.00	\$50,000.00
Traffic Management	LS	1	\$25,000.00	\$25,000.00
Storm Water Pollution Prevention	LS	1	\$8,000.00	\$8,000.00
Sidewalk	SF	10,000	\$15.00	\$150,000.00
Curb and Gutter	LS	4100	\$50.00	\$205,000.00
Ramp	SF	5,000	\$18.00	\$90,000.00
Adjust Manholes	EA	8	\$500.00	\$4,000.00
Adjust water Valves, Water Meters, Cleanouts and Monuments to Grade	EA	30	\$300.00	\$9,000.00
Asphalt Concrete Pavement	Ton	2,400	\$130.00	\$312,000.00
Pavement Reinforcing Fabric	SY	7,000	\$3.00	\$21,000.00
Class II Aggregate Base	Ton	6,000	\$45.00	\$270,000.00
Traffic Stripes (4" Thermoplastic)	LF	1,700	\$4.00	\$6,800.00
Traffic Stripes (6" Bike Lane)	LF	6,000	\$5.00	\$30,000.00
Pavement /Curb Markings (Paint)	SF	1,000	\$2.00	\$2,000.00
Crosswalk Markings (Thermoplastic)	SF	1,000	\$3.00	\$3,000.00
Pavement Markings Thermoplastic)	SF	1,100	\$3.00	\$3,300.00
Signs	EA	10	\$300.00	\$3,000.00
48" SD Manhole	EA	3	\$3,500.00	\$10,500.00
Curb Inlet	EA	7	\$3,000.00	\$21,000.00
36" HDPE	LF	900	\$220.00	\$198,000.00
Concrete Headwall	EA	1	\$3,000.00	\$3,000.00
Street Lights	EA	10	\$3,400.00	\$34,000.00
Earthwork	LS	1	\$10,000.00	\$10,000.00
Landscaping	LS	1	\$10,000.00	\$10,000.00
Construction Subtotal				\$1,478,600.00
10 % Contingency				\$147,860.00
Construction Total				\$1,626,460.00
CITY MATCH				
Environmental	LS	1	\$150,000.00	\$150,000.00
Engineering, Right of Way, Materials Testing, Construction Management	LS	1	20% Of Const Cost	\$295,720.00
Estimated Total for Engineering & Construction				\$2,072,180.00

Project Readiness:

Project Milestone			Proposed
Project Study Report Approved			6/2014
Begin Environmental (PA&ED) Phase			7/2014
Circulate Draft Environmental Document	Document Type	N/A	11/2014
Draft Project Report			4/2015
End Environmental Phase (PA&ED Milestone)			1/2016
Begin Design (PS&E) Phase			7/2014
End Design Phase (Ready to List for Advertisement Milestone)			6/2016
Begin Right of Way Phase			6/2016
End Right of Way Phase (Right of Way Certification Milestone)			1/2017
Begin Construction Phase (Contract Award Milestone)			6/2017
End Construction Phase (Construction Contract Acceptance Milestone)			12/2018
Begin Closeout Phase			1/2020
End Closeout Phase (Closeout Report)			6/2020

Does project have a completed Project Study Report (PSR) or equivalent? Yes _____ No X
 If yes, indicate date and who performed PSR _____
 If no, will PSR be performed in-house, by state, or through MCOG? _____ In-House ___ Yes _____
 Estimated PSR completion date 12/12/13 (PSRs due prior to STIP programming)

Is project consistent with current Regional Transportation Plan? Yes X No _____
 If no, has an RTP amendment been requested? _____
 Is project identified in other plans? Yes X No _____ If yes, which one(s)?

Baechtel Road – Railroad Avenue Corridor Community Design Study, October 2003

Will project implement a specific plan that has been developed for the area? Yes X No ___ If yes, which one?

Baechtel Road – Railroad Avenue Corridor Community Design Study, October 2003

Environmental Clearance Status – The City is seeking funding to complete the environmental assessment for this project.

NEPA/CEQA (circle one or both) Status Pending
 Categorical Exemption _____ Negative Declaration _____ EIR _____
 Adoption Date _____ Date of Filing _____

Permits Required Pending Status Pending

If the project is on or adjacent to a highway, street, or road, what is the Average Daily Traffic (ADT) of the facility?

In 2013 GHD performed a traffic study for The City of the Railroad Avenue Bridge, the existing ADT is 60 for the Railroad Avenue Bridge – which currently only serves one lot on the South side. The projected weekday ADT is between 426 and 486 trips per day for the proposed development.

Is this project considered urgent? Yes ____ No X if yes, explain why. _____

How does this project address the 2008 Complete Streets legislation (AB 1358)?

The ultimate project is envisioned to be a two-lane parkway that is capable of accommodating mixed residential, commercial and industrial traffic while incorporating sidewalks, bike lanes and “complete street” features (such as street trees, street lights, ADA ramps, etc.) to make the street safe and attractive for all modes of transportation. Roundabouts at Railroad Avenue and Baechtel Road will help maintain traffic flow while allowing safe pedestrian and bicycle travel.

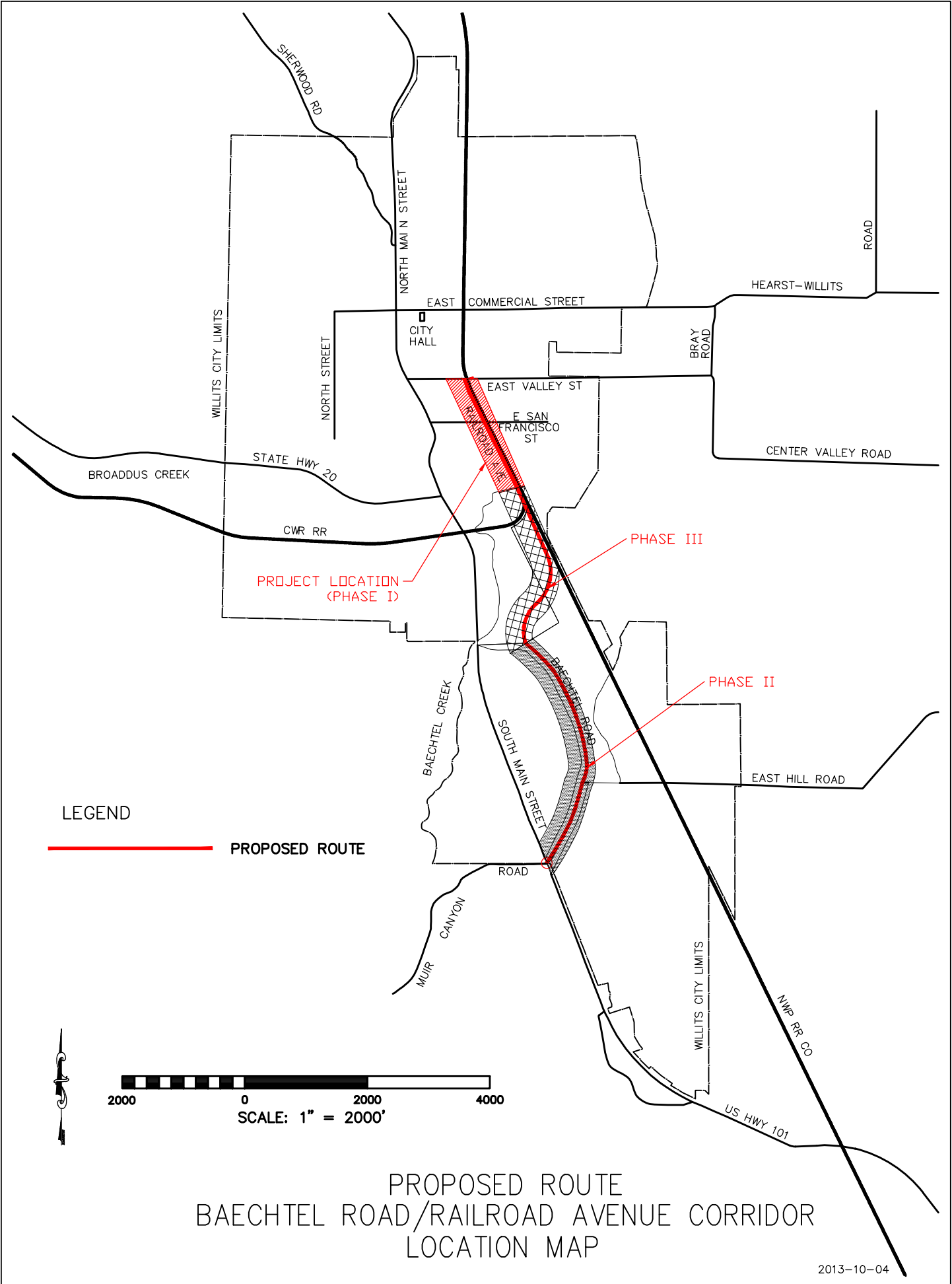

BAECHTEL - RAILROAD AVENUE CORRIDOR PROJECT PHASE I OVERVIEW

OCTOBER, 2013



SCALE: 1"=150'

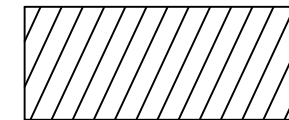
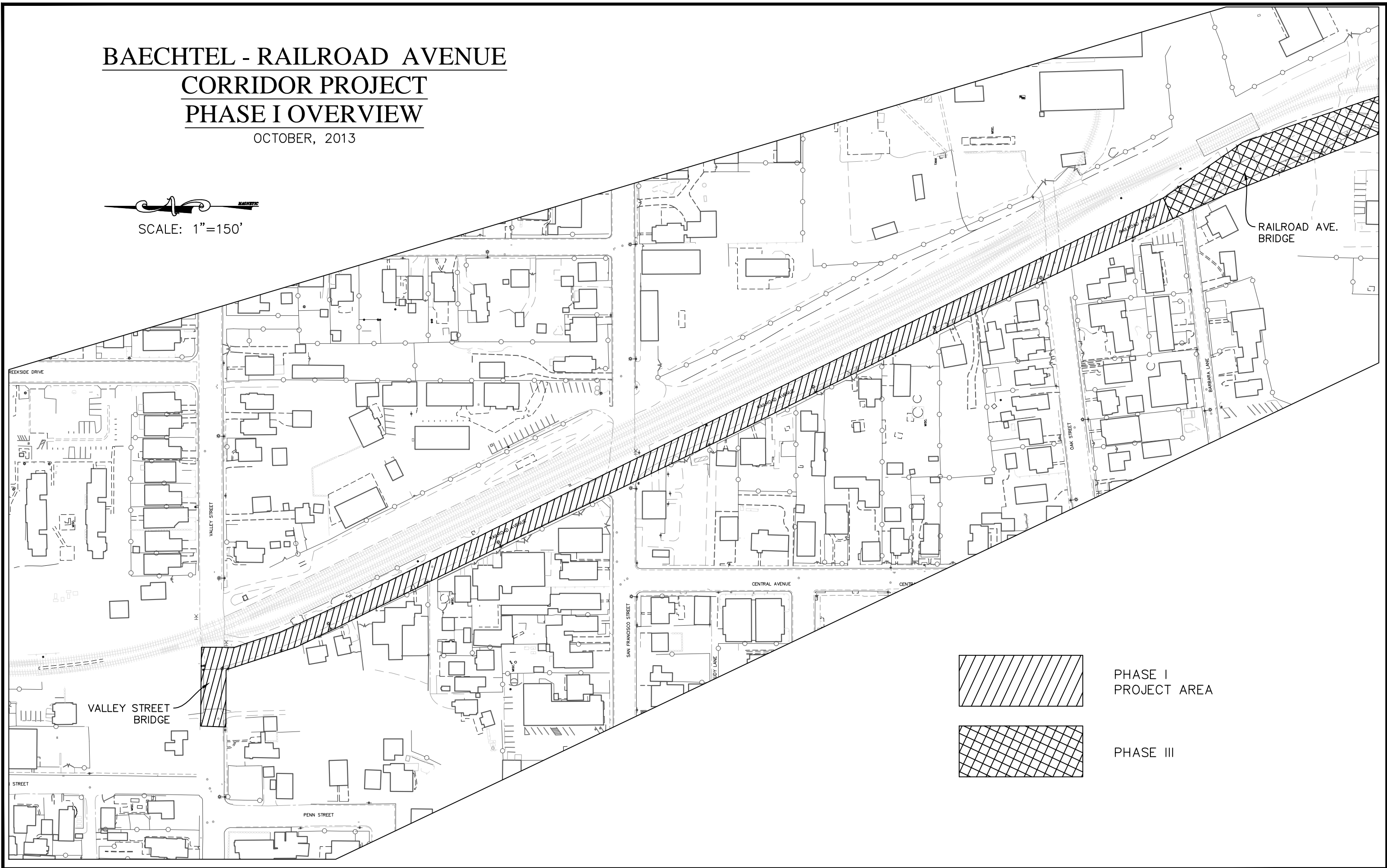

PHASE I
PROJECT AREA

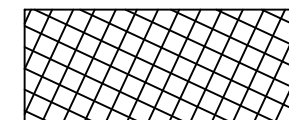

PHASE III